

RECESSED IN Grid-CEILING FRAME

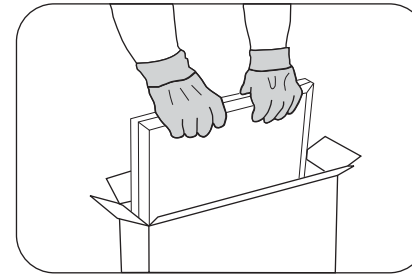

① Took the panel out of the box and protective bag. Remove the protective film.

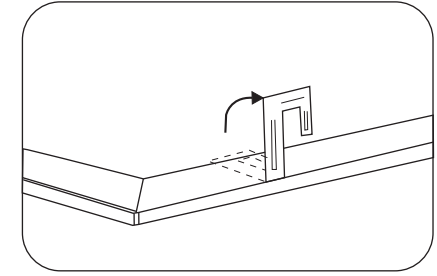

② Lift the mounting clip on the edge of panel.

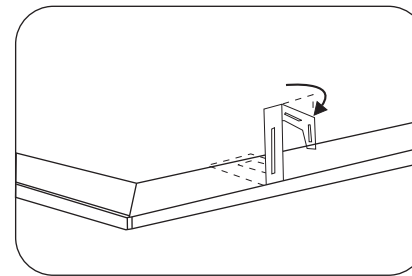

③ Turn the mounting clip head

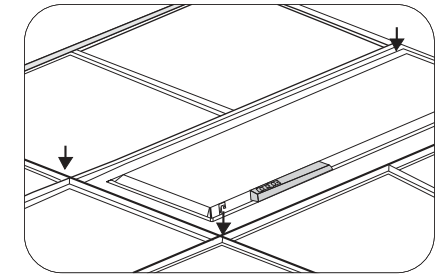

④ Put the panel into grid ceiling.

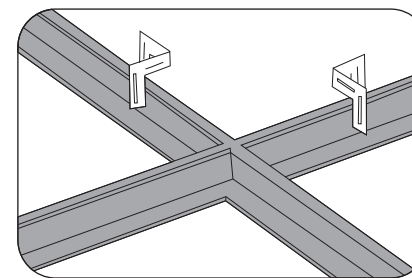

⑤ Check the clips well fasten to T-BARM (Main/Cross ceiling tee.)

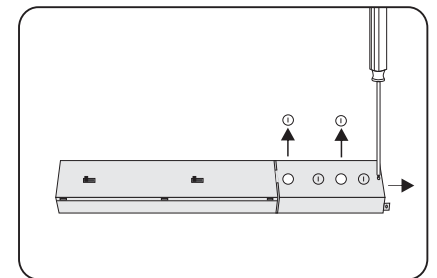

⑥ Remove the driver box cover.

Luma LED Back-Lit Panel Light 1'x4'

Installation Guide

RECESSED Grid- CEILING

(For BLIT Frame Series)



BEFORE YOU BEGIN

Read these instructions completely and carefully

⚠ WARNING/AVERTISSEMENT

RISK OF ELECTRIC SHOCK

- turn power off before inspection, installation or removal.
- properly ground electrical enclosure.

RISK OF FIRE

- follow all NEC and local codes.
- use only UL approved wire for input connections. Input wire minimum size is 18 AWG, and the output wire Minimum size is 24 AWG.

RISQUE DE DECHARGES ELECTRIQUE

- Coupez l'alimentation avant d'inspecter, installer au deplacer le luminaire.
- Assurez-vous de correctement mettre a la terre le boiter d'alimentation electrique.

RISQUE D'INCENDIE

- respectez tous les codes NEC et codes locaux.
- N'utilisez que des fils approuvées par UL a IEC pour les entrees/sorties de connexion taille minimum 18 AWG

Prepare Electrical Wiring

- Refer to PL Series LED Panel Specification for to the lamp electrical data info.

Save These Instructions

- Use only in the manner intended by manufacturer. If you have any questions, contact the manufacturer.



Electrical Requirements

The LED luminaire must be connected to the mains supply according to its ratings on the product label.



Grounding Instructions

The grounding and bonding of the overall system shall be done in accordance to local electric code of the country where the luminaire is installed.

⚠ CAUTION

Do Not perforate the integrity of the luminaire, only screw into the threaded mounting bracket holes located at the four corners of the fixture.

Storage Info

Environmental Operating Temperature Range
Environmental Rating

Max. 40°C
Dry or Damp location only

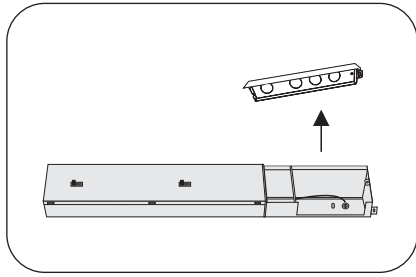

⑦ Open the knockout hole.

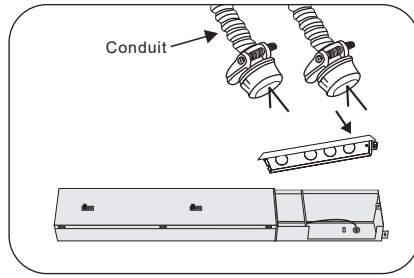

⑧ Insert the cable into driver box.

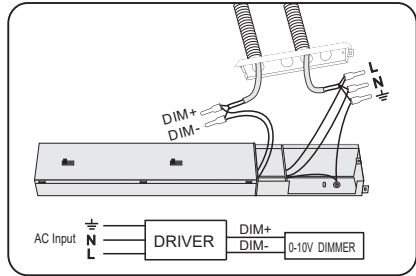

⑨ Please connect all cables with connectors one by one according to the wiring diagram. Please note that the wires passing through the entry holes need protective jackets, and pay attention to grounding.

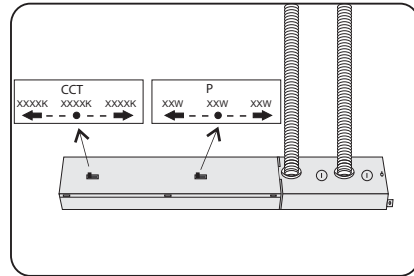

⑩ Adjust the toggle switch, and customers can choose the wattage and color temperature of lamps on site according to their own needs.

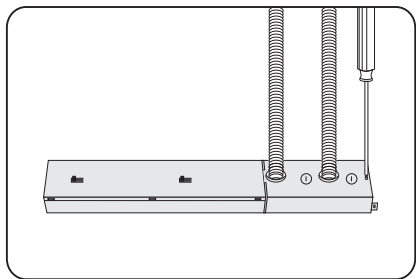

⑪ Fix the driver cover back.

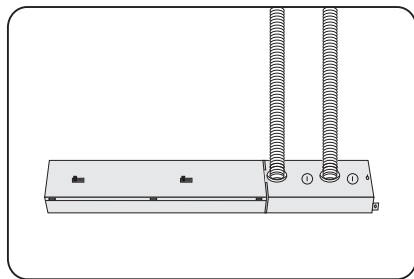

⑫ Complete.



Luma LED Back-Lit Panel Light 1'x4'

Installation Guide

RECESSED Grid- CEILING

(For BLIT Frame Series)